

NV21FTG Tiller Quick Start Guide

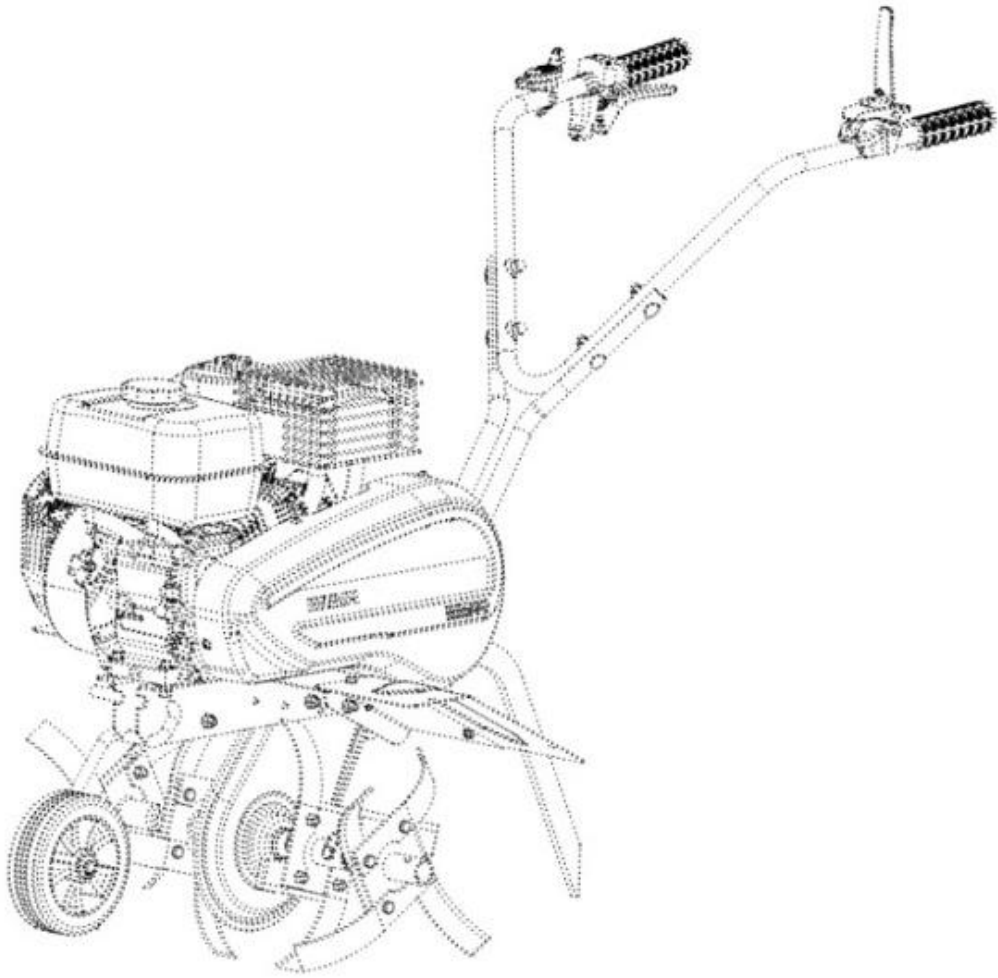

Please read the operator's manual and safety warnings carefully before use

1. Package

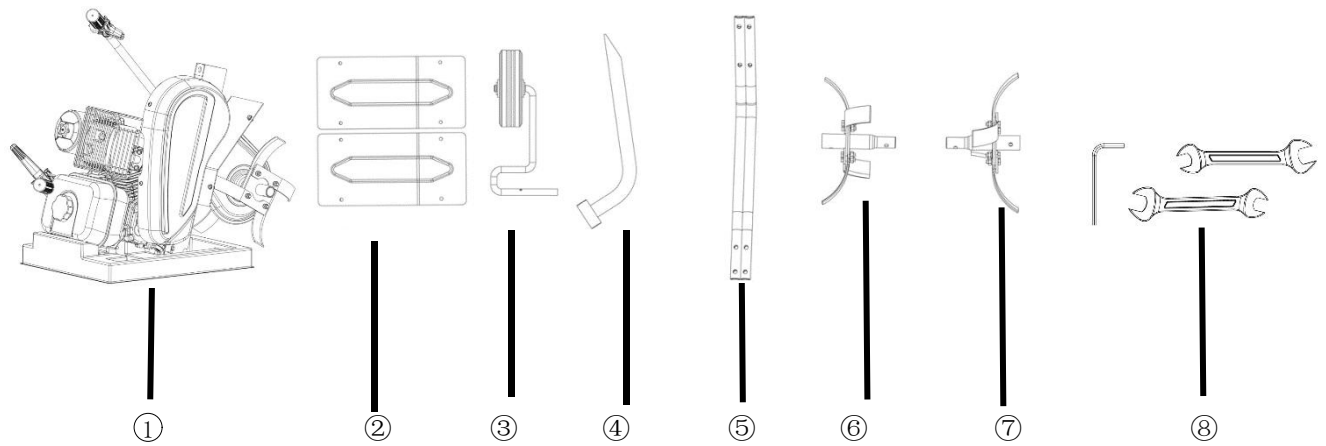

- ① Tiller ② Side Tine Shield ③ Front Wheel Assembly ④ Resistance Rod ⑤ Handle Connect Bending Pipe ⑥ Left Outer Tine ⑦ Right Outer Tine ⑧ Tools

2. Assembly

2.1 Install Outer Tines

Install left and right outer tines into the barrel of inner tine respectively. It should be noted that after assembly, the edge of the outer tine and the inner tine must be consistent. Then use snap retainer pin to fix the outer tines.

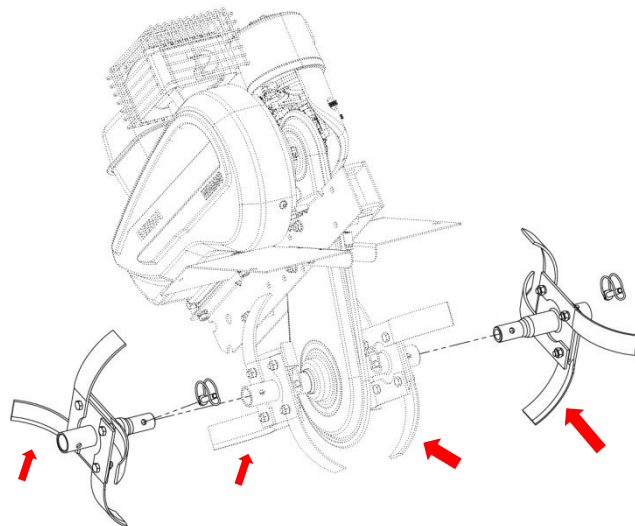

2.2 Install Resistance Rod

Use hexagonal head bolts M14×90 to install the resistance rod into the corresponding hole at the rear of the engine bracket, then secure it with M14 locking nut.

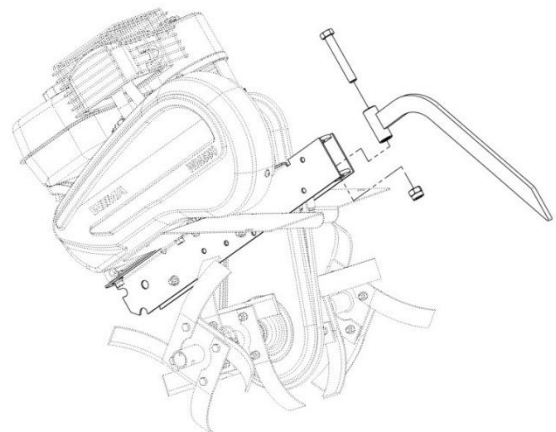

2.3 Install Front Wheel

Insert the front wheel support rod into the corresponding round hole at the front end of the engine bracket. After passing through the engine bracket, fix another end with circlip B.

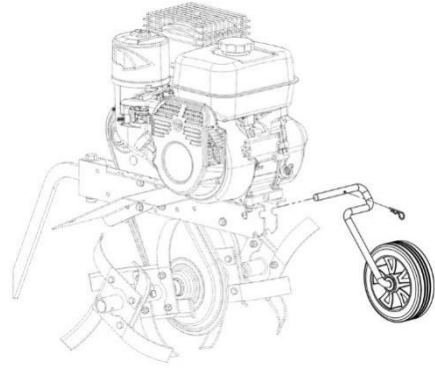

2.4 Install Handle Connect Bending Pipe

Use two M8×90 bolts to assemble the handle connect bending pipe into the corresponding hole at the rear of the engine bracket. Then fix it with two M8 lock nuts.

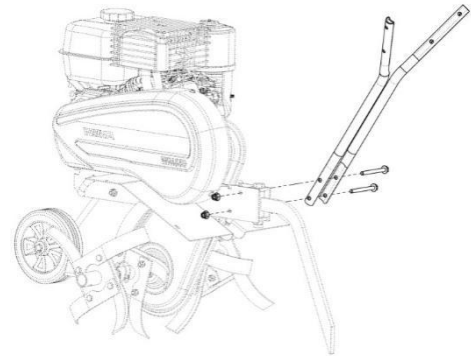

2.5 Install Handle

Use four M8×45 bolts to pass from one side of the handle connect bending pipe to the other side. Then fix the other side with washer and M8 acorn nut.

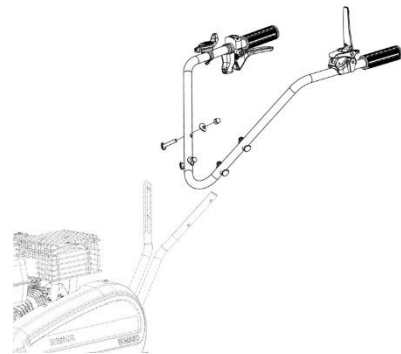

2.6 Install Side Tine Shields

Use four hexagonal flange bolts M6×12 and hexagonal flange nuts M6 to assemble the side tine shields on the outside of the main tine shield.

Note: The side tine shields are not divided into left and right.

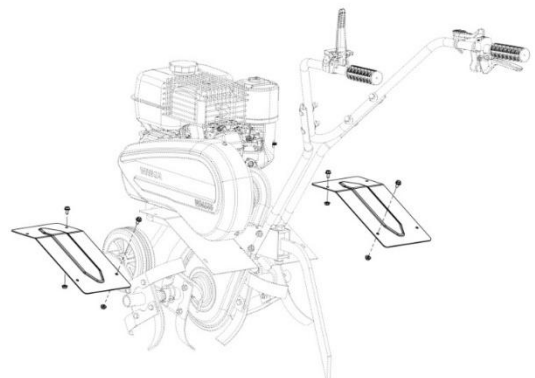

2.7 Finish

Check whole machine, and see if there are other parts left.

3. How to start

3.1 Preparation before starting

3.1.1 Turn counterclockwise to remove oil dipstick, add 0.6L engine oil into the engine oil sump.

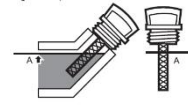
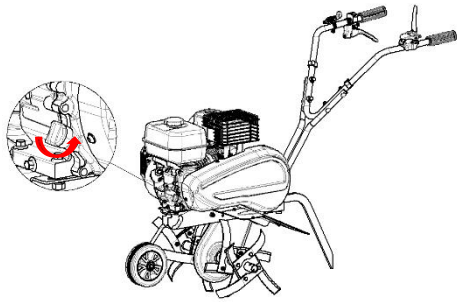

Check engine oil. The engine oil level should be within the mark on the oil dipstick.

3.1.2 Turn counterclockwise to remove the fuel tank cap. Add gasoline to the tank, and then tighten the fuel tank cap clockwise.

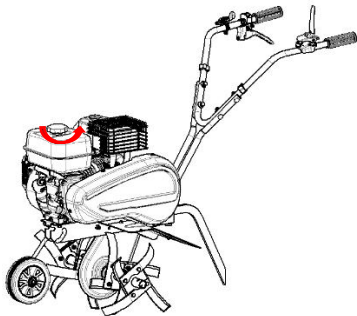

3.1.3 Remove the circlip B on the front wheel support rod, adjust the front wheel support rod upward to another position, and then install the circlip B.

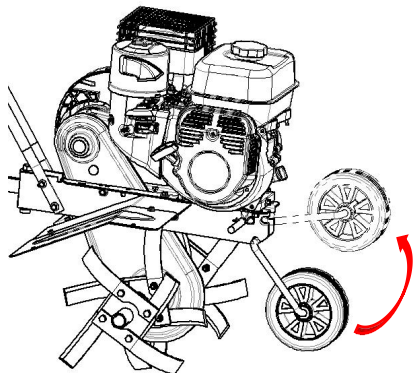

3.3 Start Tiller

3.2.1 Turn the engine switch to ON position, then turn the fuel valve to right to open, and turn the choke lever to left to close.

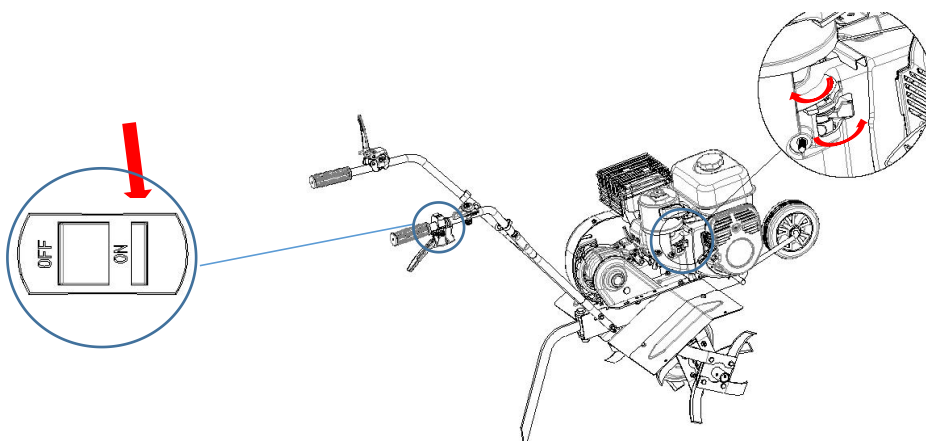

3.2.2 Pull recoil slowly until you feel resistance, and then pull it quickly. When engine rotates continuously, wait for 10 seconds, and then slowly turn choke to place of OPEN.

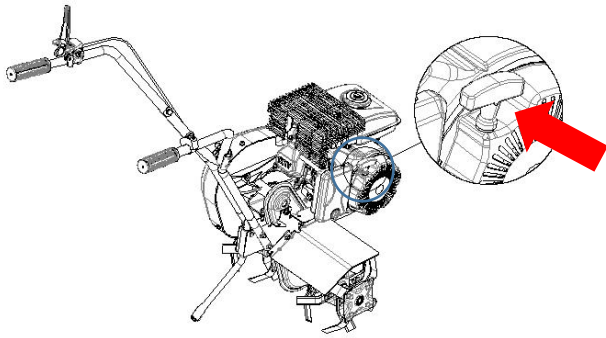

3.2.3 Turn the throttle control lever toward the inside of the tiller handle to the farthest position. Then press the tail of the lock buckle to unlock, press the clutch handle, and the tiller will start.

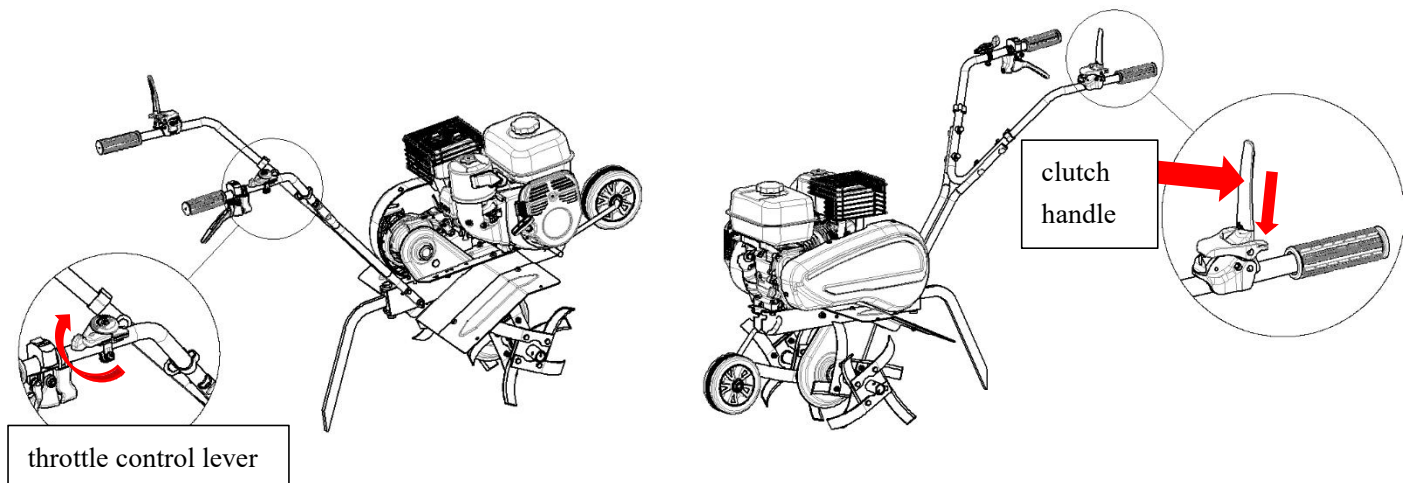

3.2.4 If you want to walk the tiller reversely, release the clutch handle, turn the throttle control handle to 1/3 position, then squeeze the reverse gear lever on the right handle bar, press the clutch handle again, and the tiller will start to walk backwards at a slow speed. At this time, you need to pay attention to the balance of the tiller.

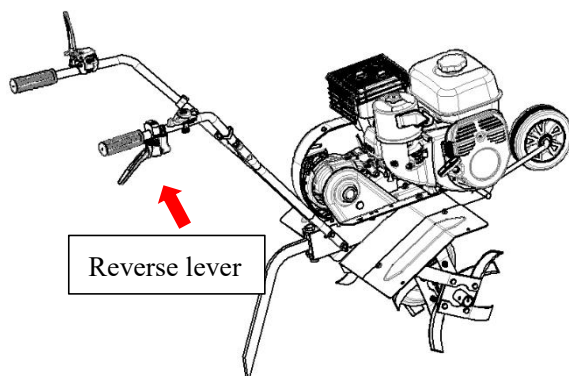

3.2.5 When tilling completes, turn the engine switch to OFF, and the tiller will stop.,